



LA · VALISE
SAN · MIGUEL



LA · VALISE

Namron Hospitality's flagship brand, La Valise, with its evocative name meaning "suitcase" in French, embodies the essence of travel at its core. Just as opening a suitcase unveils a world of unique treasures, La Valise promises a one-of-a-kind journey. La Valise invites cultured and curious souls to embrace the spirit of exploration. It is a sanctuary where each traveler finds their own narrative, immersed in meticulously designed spaces and exceptional guest service.

As a luxury brand of intimate boutique hotels, La Valise curates truly unique stays for our guests. With properties in Mexico City, Tulum, and San Miguel de Allende, we provide elevated offerings and personalized service, reflecting our commitment to a curated experience. La Valise has received recognition from prestigious travel media and is proud to be a member of the highly esteemed Small Luxury Hotels of the World accreditation.

AS UNIQUE,
as our **GUESTS.**





THE STORY

After successfully establishing La Valise in Mexico City, hotelier Yves Naman searched for a property in the colonial city of San Miguel de Allende that had long enamored him. In 2017, he discovered an oasis on a pedestrian-only cobblestone street in the city's center, adorned solely with Pedro Friedberg's artwork on the existing structure. "We could not believe the scale of the art and uniqueness of the property, and we instantly knew this property was the right one for La Valise," says Yves.

The project spanned more than five years, starting when Naman established his company, Namron Hospitality, and subsequently opened five new hotels in Tulum. La Valise San Miguel has been thoughtfully designed by Naman and decorated by Roberto Ayala, our Head of Design, who boasts an eclectic taste that resonates with the brand. The space features six suites, branching off from the courtyard and leading toward the rooftop, offering guests a chance to revel in the beauty of San Miguel de Allende.

Since 2022, La Valise San Miguel has proudly been a part of Small Luxury Hotels of the World, further enhancing its reputation for luxury and excellence.





THE PROPERTY

Nestled within the vibrant streets of San Miguel de Allende, La Valise unveils an oasis of tranquility concealed behind a captivating colonial facade. Step through the hotel's contemporary circular entrance, and a world of timeless elegance unfolds before you. At the heart of La Valise, a serene courtyard awaits, adorned with cascading plants, tranquil pools, and captivating art installations by Pedro Friedeberg. Each of the 6 magnificent suites surrounding the patio exudes its own unique charm, featuring bespoke artwork and SPA-inspired bathrooms. Our hotel is a testament to art and design, evoking the ambiance of a curated gallery. The seamless integration of design, culture, and the surrounding natural environment transforms La Valise into a true masterpiece.







DESIGN

La Valise's polychromatic spaces highlight the uniqueness of Mexican craft and Aztec symbolism, further decorated with an ensemble of contrasting modern accents and thoughtful bulbous fixtures. The distinct shapes unite the post-romantic marriage of styles in an alcove of past and present.

Each space feels like a cabinet of curiosities or as though you're stepping into Wes Anderson's wildest dreams. Each space unveils an array of design decisions and objets d'art as if one would bring them in their suitcase from all the corners of the world. Thus each room creates the artful, cozy ambiance of a meticulously designed home.





MASTER SUITE

THE GRANDE DAME ON THE UPPER FLOOR

Our largest suite is designed to function as the ultimate San Miguel pied-à-Terre, your home away from home, and open space to explore your artist within. It features a cozy living room space for leisure and a spacious bedroom with a contrasting black and white mid-century design. The spa-inspired bathroom houses a granite tub below two cupolas filled with stars, mirrors, and shimmering light.

VIEW: GARDEN

FLOOR: UPPER

SIZE: 72 SQM / 779 SQFT

BED: KING

OCCUPANCY: 2 GUESTS

BATHROOM: SPA SHOWER & BATHTUB

A/C: 24-HOUR

LIVING ROOM

1 ROOM



C ATL SUITE

REMEMBRANCE PAST

Located on the ground floor fronted by the interior zen gardens, this breathtaking room has high wood-beamed ceilings and exudes a soothing stucco palette adorned with soft textiles. The hallmark of this luxurious suite is an antique soaking tub in front of a warm fireplace, the perfect cozy addition to San Miguel's cool evenings.

VIEW: CITY & GARDEN

FLOOR: LOWER

SIZE: 47 SQM / 513 SQFT

BED: KING

OCCUPANCY: 2 GUESTS

BATHROOM: SPA SHOWER & BATHTUB

A/C: 24-HOUR

1 ROOM



ALMA SUITE

THE CREATIVE HEART

Ornately designed, this suite looks out directly to the inner courtyard and gardens of La Valise, its soul! Aztec monkey symbolism decorates the walls of this suite above a luxurious copper bathing tub. Ozomatli, meaning "monkey," is the day in the Aztec calendar associated with the god Xochipili, the god of flowers, feasts, fun, and creativity.

VIEW: GARDEN

FLOOR: LOWER

SIZE: 42 SQM / 466 SQFT

BED: KING

OCCUPANCY: 2 GUESTS

BATHROOM:

SHOWER & BATHTUB

A/C: 24-HOUR

1 ROOM

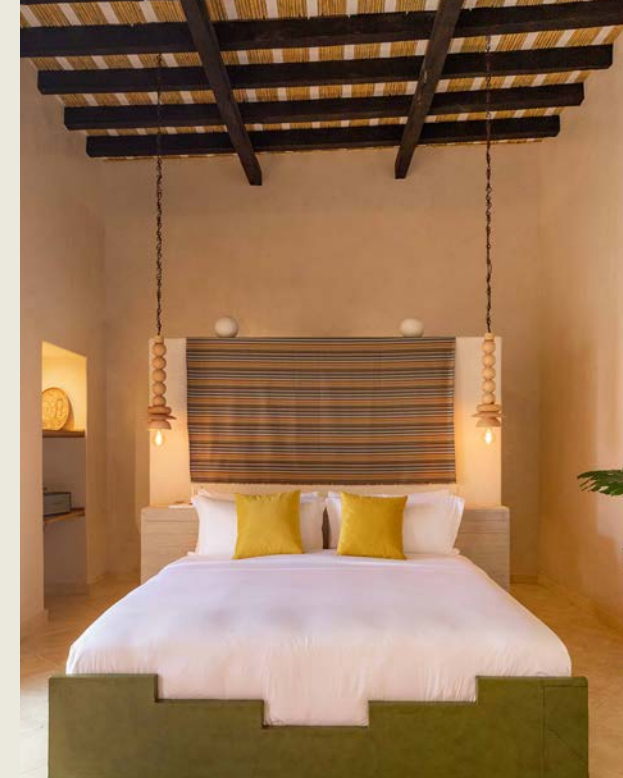

OLLIN SUITE

MOVEMENT IN ACTION

This spacious and peaceful suite features a spa-inspired Roman soaking tub enclosed by a custom-made metal bell sculpture. The room is adorned with mid-century furniture and lush textiles and boasts light-filled views of the interior zen garden. Its name yields from an Aztec sign called the "Nahui Ollin," a concept that translates as a movement.

VIEW: GARDEN

FLOOR: LOWER

SIZE: 36 SQM / 389 SQFT

BED: KING

OCCUPANCY: 2 GUESTS

BATHROOM: SPA SHOWER & BATHTUB

A/C: 24-HOUR

1 ROOM



GENESIS SUITE

AN ODE TO DIEGO RIVERA

Inspired by Diego Rivera's famous Anahuacalli Museum, this suite features three grand arches carved from local stones reminiscent of a Mayan temple. The room also boasts a Mikveh-inspired bath used for purification rituals, exuding the finest in peace and luxury.

VIEW: POOL

FLOOR: LOWER

SIZE: 63 SQM / 679 SQFT

BED: KING

OCCUPANCY: 2 GUESTS

BATHROOM: SPA SHOWER & BATHTUB

A/C: 24-HOUR

1 ROOM



AURA SUITE

SWEEPING CITY VIEWS

This upper-level suite boasts sweeping views of downtown San Miguel's main square, the iconic Cathedral, and the interior gardens of La Valise and Pedro Friedeberg's mural. Inside you'll find neutral tones, sleek furniture, and soft organic textiles. It also features a private terrace with an outdoor shower.

VIEW: CITY, GARDEN & POOL

FLOOR: UPPER

SIZE: 24 SQM / 260 SQFT

BED: KING

OCCUPANCY: 2 GUESTS

BATHROOM: SHOWER
& OUTDOOR BATHTUB (SEPARATE)

A/C: 24-HOUR

1 ROOM





LA · VALISE
SAN · MIGUEL

Second Floor



First Floor

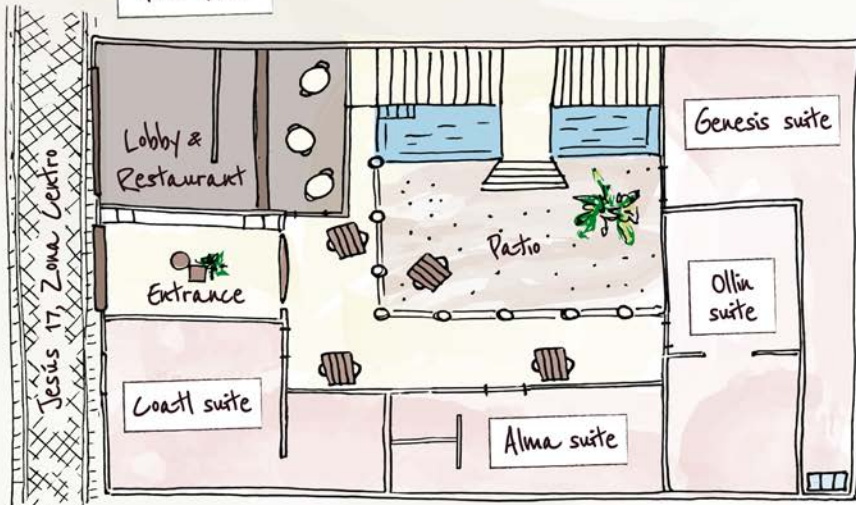

OUR LOCATION

Located at Jesús 17, Zona Centro, La Valise San Miguel de Allende positions you right in the heart of the colonial city. Seamlessly blending with the neighboring buildings along cobblestone streets on a pedestrian-only street, our hotel hides an oasis of tranquility behind its vermillion facade, just steps away from Jardín Allende and the Parroquia de San Miguel Arcángel. Our central location provides easy access to the city's rich heritage and is a short walk from the contemporary art center at Fabrica la Aurora. Additionally, we are surrounded by acclaimed culinary destinations, including The Restaurant, Bovine, Trazo 1810, and more. Just a short drive from the city, you can discover hot springs and a variety of local wineries.





AMENITIES

All of our spacious en-suite bedrooms, ornately outfitted within the most beautiful of settings, ensure total relaxation day and night. Our rooms and property provide the following luxury amenities & features:

Daily complimentary breakfast

Daily housekeeping

King-size bed

Luxury bedding and linens

Luxury bathrooms with complimentary Loredana toiletries

In-room Marshall speaker

In-room Nespresso coffee machine

Minibar

Vanities

Hairdryer

In-room safe

Free WiFi

24-hour air conditioning & heating

24-hour concierge service



OUR SERVICES

EXPERIENCES

San Miguel de Allende, located at the heart of natural, cultural, and historical exploration in the Guanajuato region of Central Mexico, offers a rich tapestry of experiences waiting to be discovered. La Valise provides abundant intimate and exclusive experiences, along with thoughtfully curated expeditions by land and air led by our local guides. Guests are encouraged to discover a variety of bespoke and unique experiences in their own way, gaining a new appreciation for the essence of Mexico's past and present.

We have designed immersive experiences to entice the senses, engage the body, uplift the soul, and connect you to the origins of this remarkable land. When your journey with us is complete, we want you to feel changed, inspired, and lighter, with a new appreciation for life. Our dedicated team of local experts offers tailor-made itineraries that guarantee a truly authentic stay with us at La Valise.

WELLNES & SPA SERVICES

An extensive SPA menu brings the excellence of a private spa directly to your suite at La Valise San Miguel. Our experienced therapists offer an array of massages, facials, and therapists to address your body, mind & soul. Every treatment is bespoke and personalized, sure to address every guest's needs and desires to ensure an even more relaxing stay at our property.

Our expert healers are here to offer bespoke treatments within the suite's comfort, catering to individual needs.





GASTRONOMY

BREAKFAST

Enjoy a fresh breakfast from the comfort of your suite or bench on our property featuring local ingredients and something for your every mood every morning. Enjoy healthier choices such as tropical smoothie bowls, or opt for local pastry delicacies paired with fresh juice and craft coffee.

**Complimentary breakfast includes:*

Continental breakfast and one main course from the menu

ROOM SERVICE

Guests are invited to order from our room service menu and enjoy delicious provisions within their suites and/or across our property. While we do not have a full-service restaurant, we offer an array of bites, wines, and cocktails to supplement your stay with us on a culinary note.



MEXICAN STYLE ASSOULIN



NAMRON
HOSPITALITY



LA · VALISE
SAN · MIGUEL



WWW.LAVALISE.COM